

Abilene

Zoo master plan

Resending 2 pages

Abilene Zoological Gardens
 Abilene Zoological Gardens
 June 13, 2002
 NORTH

**ABILENE ZOOLOGICAL GARDENS
 MASTER PLAN**

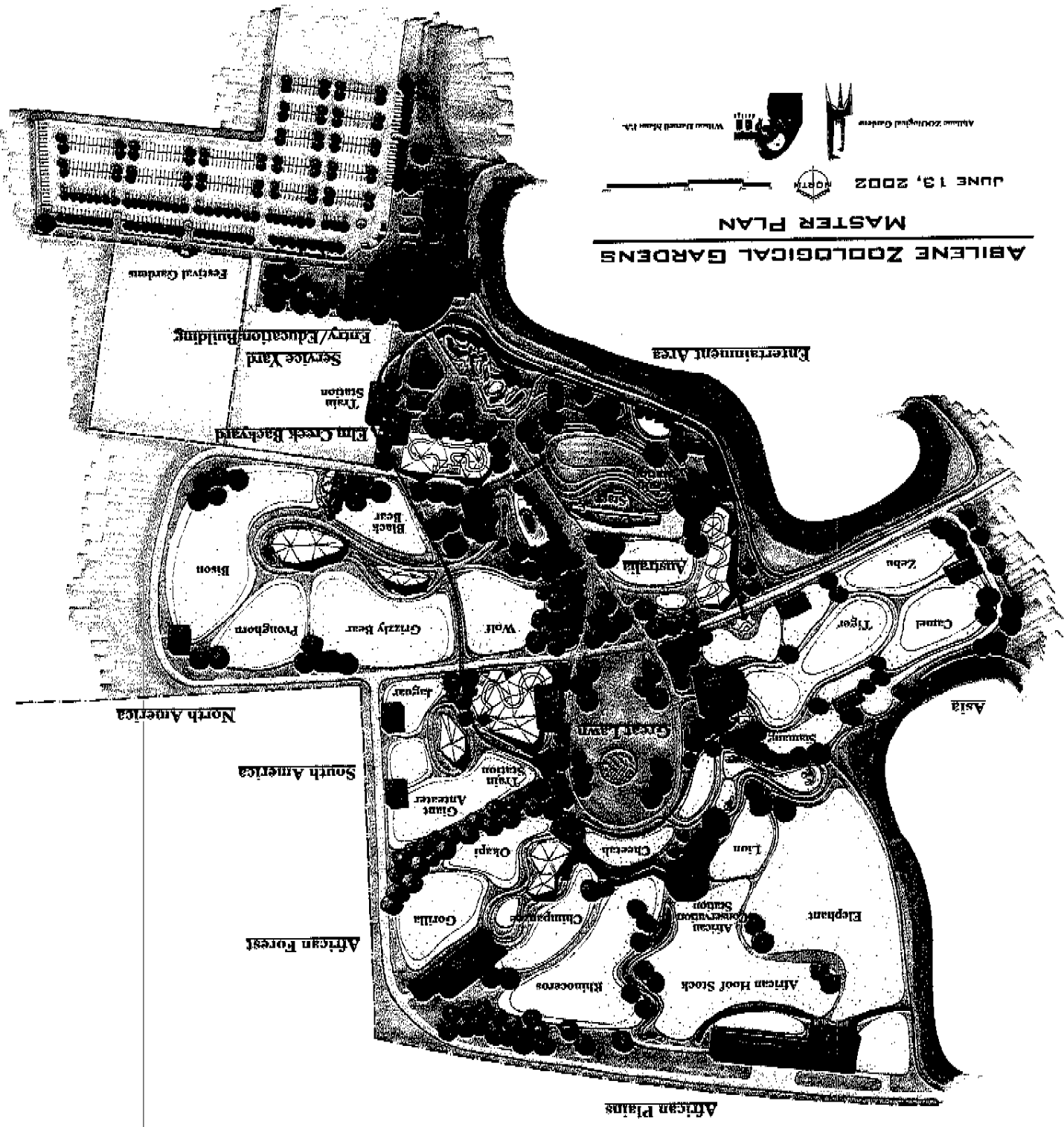

African Plains
 African Hoof Stock
 Elephant
 African Lion
 African Savanna
 Rhinoceros
 Gorilla
 Chimpanzee
 Okapi
 Giant Anteater
 Jaguar
 South America
 North America

Entertainment Area

Asia

Service Yard
 Train Station
 Entry/Education Building
 Elm Creek Backyard
 Feydial Gardens

Australia

Zebu

Tiger

Cattle

Wolf

Grizzly Bear

Black Bear

Bison

Grand Entry

Savanna

Elephant

African Hoof Stock

Rhinoceros

Chimpanzee

Okapi

Giant Anteater

Jaguar

South America

North America

African Plains

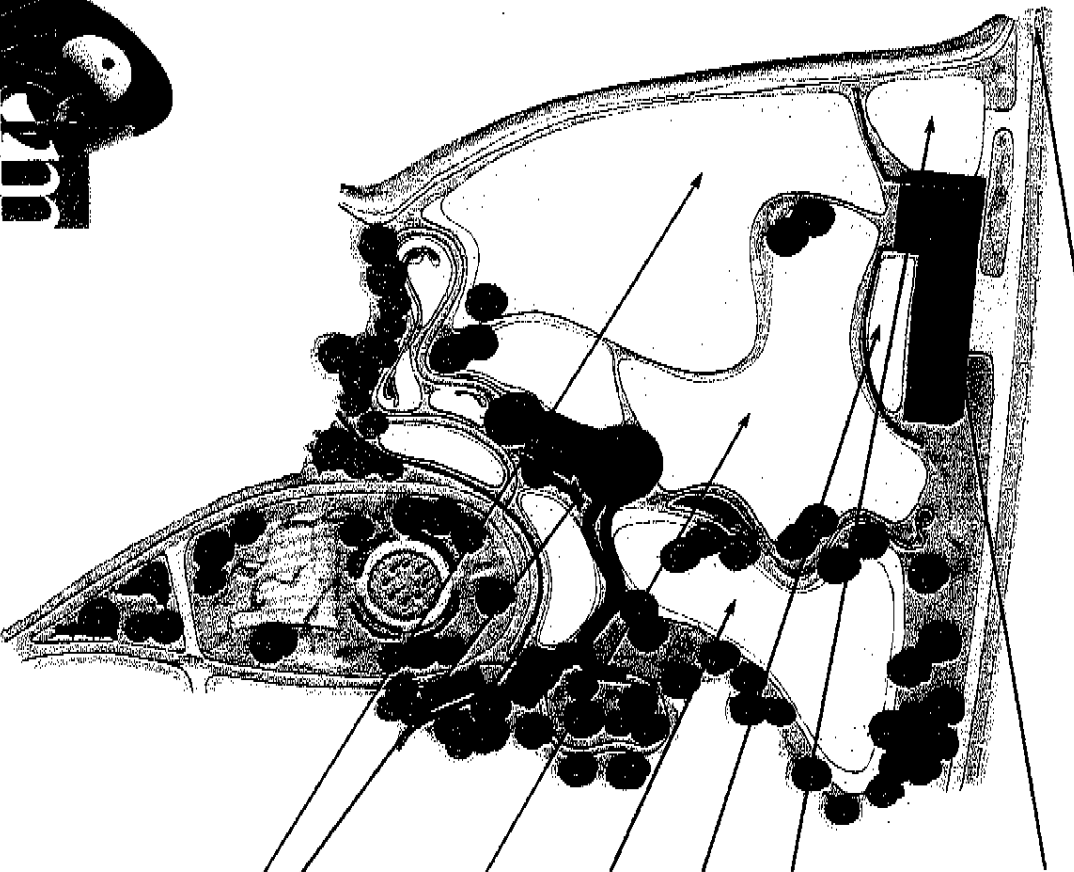

Service Road and Perimeter Fence

- New gravel service road will follow the new perimeter fence around zoo property.
- Keeper access to all exhibits and holding buildings from perimeter service road.

African Plains Holding Building

- 30,000 s.f. holding for giraffe, elephant and rhinoceros.
- Each species has separate transfer chutes to the individual yard.
- Treatment areas for the animals will also be included in the holding building.
- The building will have an office, diet prep and food storage areas and telephone and fiber optic connections to the zoo.
- All USDA and AZA requirements for keeper/animal contact will be incorporated.

Bull Elephant Outdoor Yard

- 12,000 s.f. off exhibit yard built for containment of bull elephants as required by the USDA and AZA.

Off Exhibit Outdoor Yards

- 8,000 s.f. yard for holding any large African species outdoors and off-exhibit.

Rhinoceros Exhibit

- 1 acre yard themed to represent an African savanna.
- Natural barriers and containment will be used to give guests the illusion of no fences.

Giraffe and Antelope Yard

- 1.8 acre mixed species exhibit. Giraffe and antelope will be accessible to guests at African Conservation Station.
- Natural barriers between other exhibits will give the guests an appearance of a realistic African setting.

African Conservation Station

Elephant Exhibit

- 2.5 acres of grassland exhibit. The north lake will be accessible to the elephant herd. Underwater containment of the herd will be installed.
- The west side of the north lake will be landscaped to give the guests expanded views and enhance the apparent size of the exhibit.
- The elephant yard will be viewed from 2 locations. From the African Conservation Station guest will see the elephants with lions and giraffes in the foreground. The elephant yard can also be viewed from ground level giving the guest a true scale of these large animals.

m
design

Abilene Zoological Gardens